

bilz

STA Synchro Tap Adaptor

Used with ER collet chucks and driven tools
ISO 15488 (DIN6499)



**FOR HIGHEST
PRECISION AND
QUALITY**
from the first thread



Suitable for internal coolant 50bar (MQL upon request)

Short design -
Low interference contour

Modular design - Low investment costs

Bilz quick change system - short setup times

Suitable for left and right threads, can be used for tapping and forming

Market results STA vs. rigid tapping applications

Process optimisation through reduction of axial forces

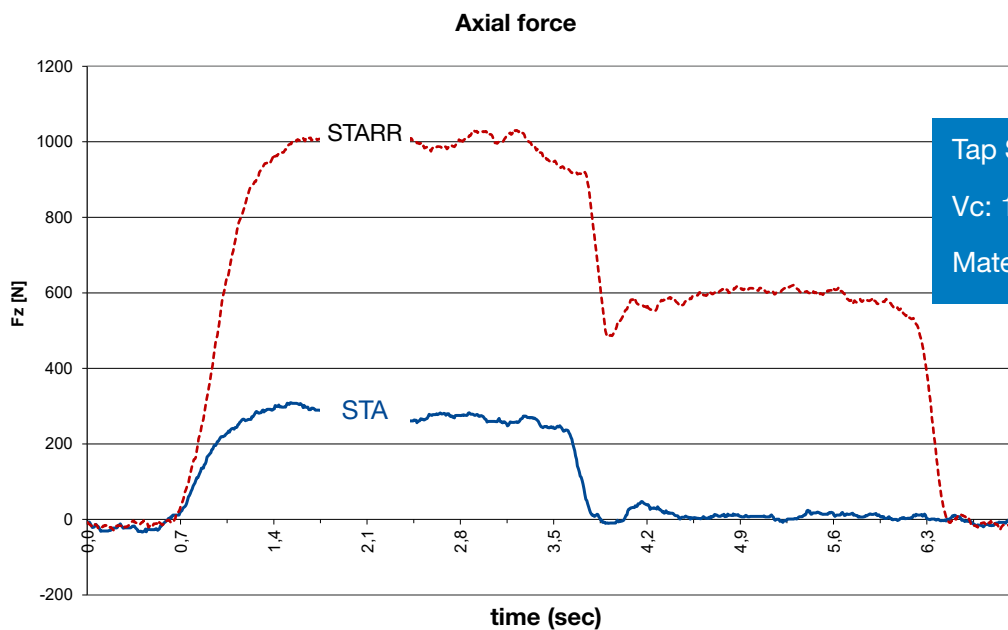



Advantages

- compensates for synchronisation errors
- reduction of axial forces on the thread flanks
- better thread quality
- can be used in tight spaces
- low maintenance

Benefits

- high productivity due to fast tool change times
- significant increase in tool life and process reliability
- reduced risk of tool breakage
- cost savings due to reduced tap inventory
- reduced spindle wear
- increase in process reliability



The new STA Synchro Tap Adaptor was designed specifically for ER collet chucks and allows for synchronised thread cutting and forming to be achieved with all suitable machines.

Features:

- for all types of tooling with or without internal coolant
- minimal length compensation with tension and compression
- optimal damping
- compact design
- allows quick tap changes

STA saves considerable time when changing taps. Optimises tap tool life and thus improves productivity and quality. Contact us for more.

STA Synchro Tap Adaptor with Ball Bushing

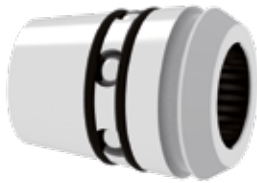

Synchro collet (STL)			
Size	Location Machine	Designation	Ident No.
2	ER16	STL2-K1-ER16	5099865
		STL2-K1-ER16	5099865
		STL2-K1-ER16	5099865
3	ER20	STL3-K1-ER20	5099856
4	ER25	STL4-K1-ER25	5099833
5	ER32	STL5-K1-ER32	5092917

Synchro Tool Head (STH)			
D1 x □ [mm]	Thread sizes	Designation	Ident No.
3,5x2,7	M3 ; M5	STH2-0350X0270-24-K1	5100071
4,5x3,4	M4 ; M6	STH2-0450X0340-24-K1	5100078
5,0x4,0	M4 ; M5	STH2-0500X0400-24-K1	5100087
6,0x4,9	M5 ; M6 ; M8	STH3-0600X0490-35-K1	5113800
7,0x5,5	M7 ; M9 ; M10	STH3-0700X0550-35-K1	5100015
7,0x5,5	M7 ; M9 ; M10	STH4-0700X0550-30-K1	5099927
8,0x6,2	M8 ; M11	STH4-0800X0620-30-K1	5099948
9,0x7,0	M9 ; M12	STH4-0900X0700-40-K1	5099939
8,0x6,2	M8 ; M11	STH5-0800X0620-37-K1	5100155
9,0x7,0	M9 ; M12	STH5-0900X0700-37-K1	5092928
10,0x8,0	M10	STH5-1000X0800-37-K1	5100154
11,0x9,0	M14	STH5-1100X0900-37-K1	5100157
12,0x9,0	M12 ; M16	STH5-1200X0900-37-K1	5100156

STA Synchro Tap Adaptor

- For ER collet chucks ISO15488 (DIN6499)
- For synchronised tapping and forming
- Coolant pressure: max. 50 bar
- Minimal length compensation: + 0,5mm / - 0,2mm

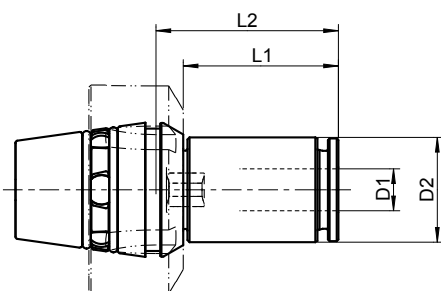

Synchro adaptor complete (STA)						
Size	D1 x □ [mm]	D2 [mm]	L1 [mm]	L2 [mm]	Torque for clamping nut Mt max. [Nm]	Transmissible torque Mt max. [Nm]
2	3,5x2,7	12,7	24	26,3	40	10
	4,5x3,4	12,7	24	26,3		
	5,0x4,0	12,7	24	27,3		
3	6,0x4,9	15,8	35	31	40	18
	7,0x5,5	15,8	35	31		
4	7,0x5,5	19	30	33,5	80	28
	8,0x6,2	19	30	34,5		
	9,0x7,0	19	40	35,5		
5	8,0x6,2	25	37	41	130	50
	9,0x7,0	25	37	42		
	10,0x8,0	25	37	43		
	11,0x9,0	25	37	44		
	12,0x9,0	25	37	44		